

# Standard Plan

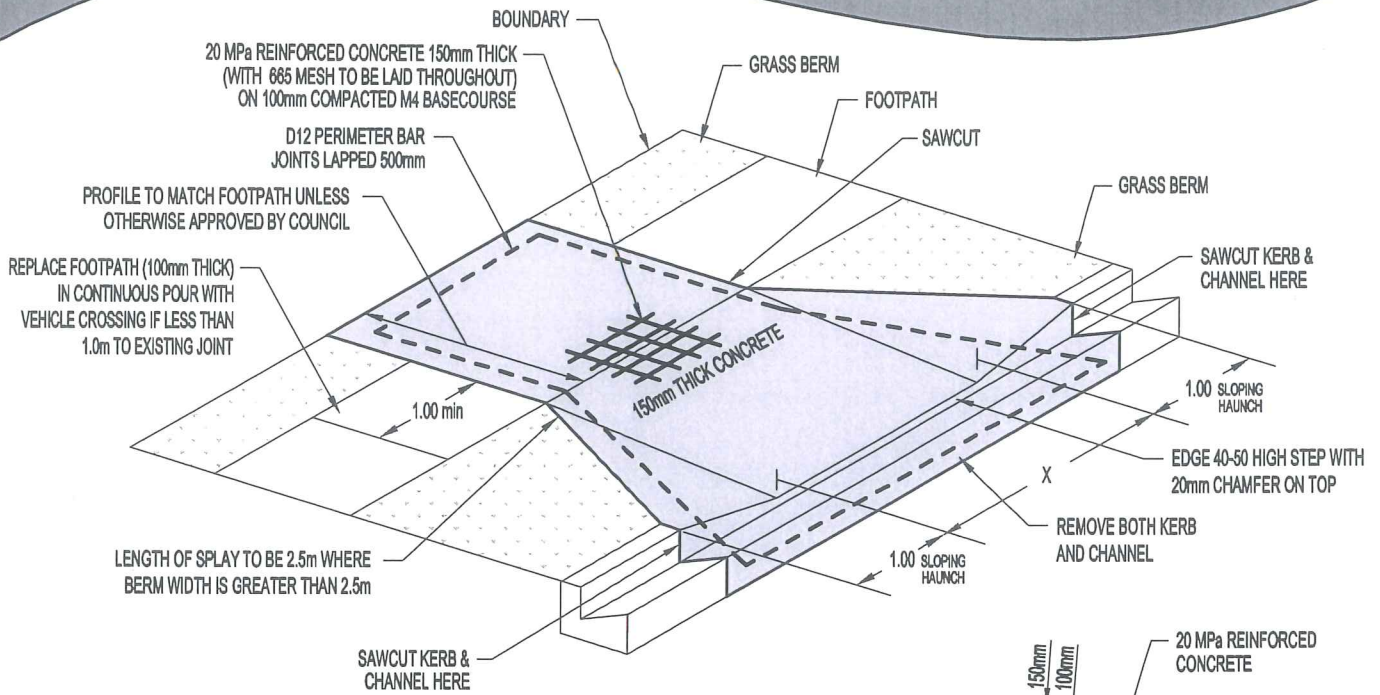

**BERM ADJACENT TO KERB**

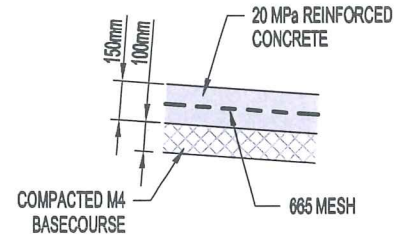

**TYPICAL SLAB CROSS SECTION**

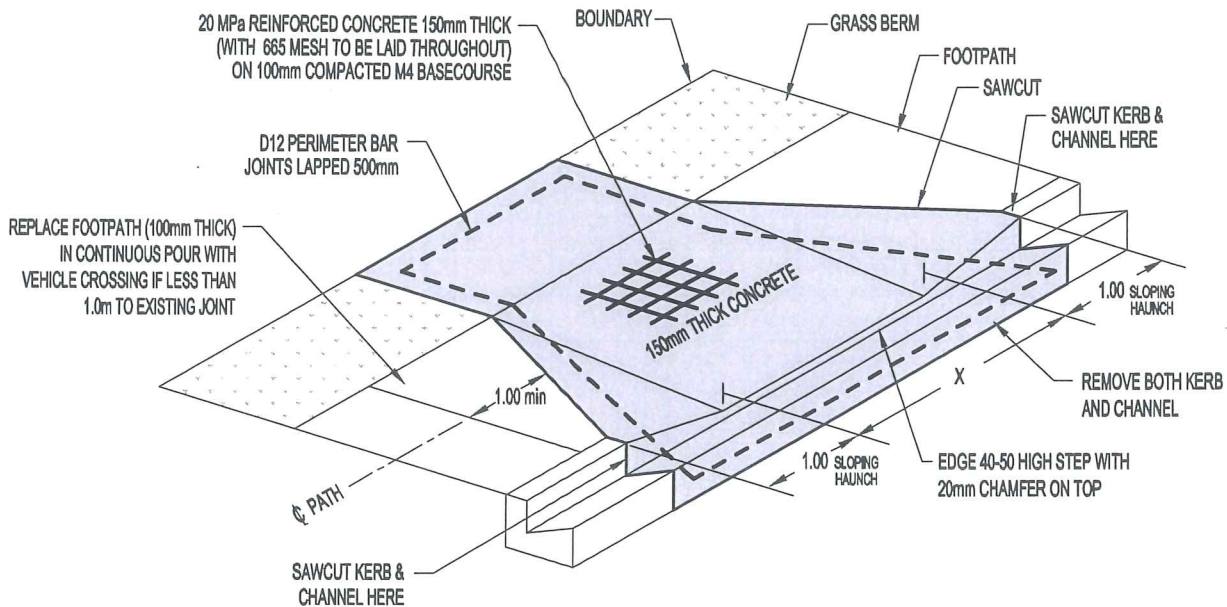

**FOOTPATH ADJACENT TO KERB**

**Heavy Duty Vehicle Crossing**

NOT TO SCALE

Approved: Road and Traffic Divisional Manager  
Hutt City Council

Approved: Director, Infrastructure Services  
Upper Hutt City Council

Standard Plan No: **CM1005 26R**  
Date: 29/10/12

**CM1005 26R**